



600 SERIES

Janus International 600 SERIES INSULATED ROLLING STEEL

SERVICE DOOR is produced with the highest quality and durability in the industry. The **600 Series** comes in 24, 22, 20 or 18-gauge slats with a flat profile and 24 or 22-gauge back slat that encloses a 5/8" thick insulation strip between the two slats. The **600 Series** is available in sizes 40'x16' to 28'x26' (varies by model). The **600 Series** is the perfect choice for industrial, commercial, or climate-controlled applications.

STANDARD FEATURES:

- Enclosed hood with baffle
- Reduction gear chain hoist
- 3-piece structural steel guides
- Double angle bottom bar with weatherseal
- 2 Year limited warranty
- Four finish options: white, gray, tan topcoats and galvanized

40 year film integrity and a 35 year no-chalk/no-fade limited paint warranty.



Maximum
40' x 30'

Available in sizes up to 40' x 30'.
Four finish options available: white, gray, tan topcoats and galvanized.



Heavy-Duty
Application

Ideal for industrial, commercial, or climate-controlled applications.



Wind Load
Rated

Superior construction and innovative design make this door able to withstand heavy winds and extreme weather.

INSULATED SERVICE DOORS



OPTIONS

- » **Electric Operation:**
Easy fast motorized operation at a push of a button (motor mounting plates available on request).
- » **Slide Bolt Locks:**
Dual steel slide bolt locks attached to bottom suitable for padlocks (padlocks by other) (standard for manual/push-up operation).
- » **Vision Panels:**
5" x 3/4" cut out spaced approximately 3" apart and covered with clear Lexan.
- » **Windload:**
Available design to +/- 50 PSF for 16' wide (22-gauge). Windload varies by size and model; for windload availability on large sizes contact customer service.
- » **Powder Coating:**
Available on all gauges flat or curved profile. Consult factory for available colors.

INSULATED SERVICE DOOR 600 MODELS

- 618 (18-GAUGE SLAT)**
- 620 (20-GAUGE SLAT)**
- 622 (22-GAUGE SLAT)**
- 624 (24-GAUGE SLAT)**

Hoods | 24-gauge galvanized steel with baked epoxy primer and/or baked polyester topcoat and designed to enclose door coil. Reinforcing to be 1/4" thick steel brackets for door over 16'0" wide.

Hood Baffle | 8" wide PVC rubber riveted to the inside of the hood.

Drum Assembly | Barrel to be a steel pipe of diameter and wall thickness to restrict maximum deflection to .03" per foot door width. Springs to be oil tempered grease packed helical torsion type designed to cycle 25,000 times. Springs are to be mounted on a cold rolled steel inner shaft. End Bearing to be self-lubricating ball bearings.

Guide Assembly | Guide angles to be 3/16" minimum thickness structural steel with 30" service cutout and removable headstops. Guide depth to provide slat penetration adequate to satisfy specified wind loading.

Slats | 24, 22, 20, or 18-gauge are manufactured from commercial grade galvanized steel and coated with Super Durable polyester paint that is backed by a 40 year film integrity and 35 year no-fade limited paint warranty.

*Insulation to be 5/8" polystyrene foam. Effective insulating value to be R=5.0 (Polyurethane Optional).

Bracket Assembly | Bracket Plates to be 1/4" minimum thickness steel plate and enclose ends of barrel assembly. Drive End Bracket Plate to be filled with a self-aligning sealed ball bearing.

Chain Hoist | Drive to consist of roller chains and sprockets. Hand Chain to be galvanized machine link. Pull not to exceed 35 lbs. (156 N).

Hand Chain Lock | Lockable bracket mounted on guide angle or wall suitable for padlocking (padlock by others).

Guide Weatherseal | One-piece vinyl weather seal attached to door guide on the non-coil side (brush seal with retainer available upon request).

Endlocks | Each end of alternate slats to be fitted with endlocks to provide a wearing surface in the guides and to maintain slat alignment. Fastened with 3/16" rivets. Windlocks provided on larger sizes.

Bottom Bar | Curtain to be reinforced with a bottom bar consisting of two 2" x 2" x 1/8" structural steel angles (depending on model and size) with PVC bulb astragal.

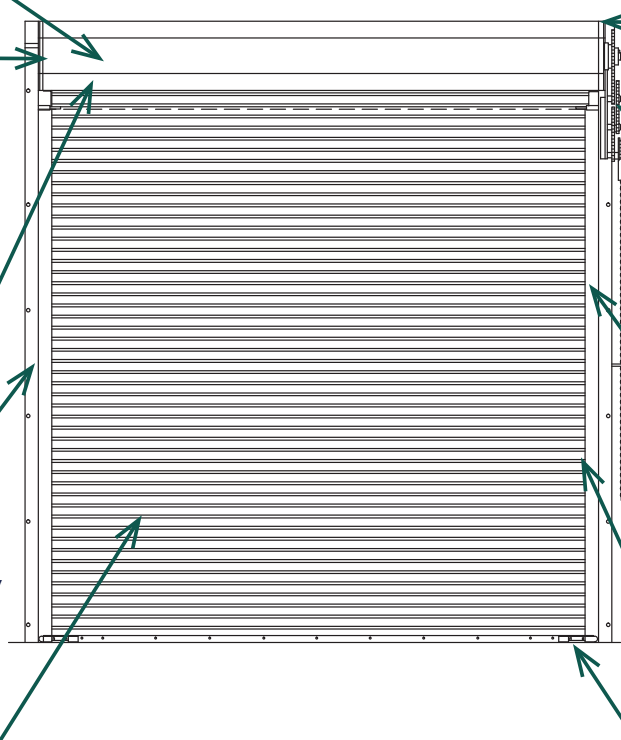

SPECIFICATION DETAILS



STANDARD GUIDE DETAILS

3 piece Structural Steel Guide

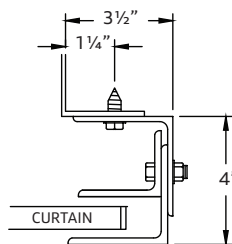

3 piece Structural Steel Windlock Guide

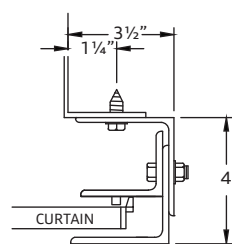

3 piece Structural Steel Windload Certified Guide

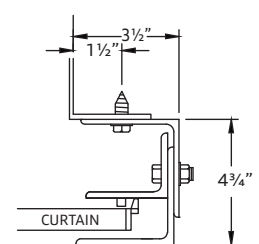

(Dimensions are approximate and vary by door size)

* For headroom and sideroom dimensions, refer to door specific shop drawings.

Janus International reserves the right to change engineering specifications without prior notice. Illustrations shown are for general reference and should be verified for construction purposes.

2024-02

HEADQUARTERS

Janus International Group
135 Janus International Blvd.
Temple, GA 30179

866-562-2580
marketing@JanusIntl.com
JanusIntl.com