



# JANUS

INTERNATIONAL

## Portable Storage Structures

**Relocatable. Portable. Foldable. Stackable.** Janus International offers storage containers in a wide range of sizes, materials and openings to meet today's temporary storage needs.



# Relocatable Storage

## Movable Additional Storage Structures



Janus International has introduced a new concept in relocatable, flexible and affordable self storage — Movable Additional Storage Structures (MASS).

MASS self storage allows owners more flexibility than traditionally constructed building structures. Portable units are an attractive and cost-effective alternative to new construction or conversions, particularly if you are in need of just a few more storage units. Because they are movable, they can be placed in areas where you would not traditionally build. Portable structures can be classified as equipment, which may offer greater tax incentives.

### Benefits:

- Easily movable by a 5,000 lb. forklift
- Can be built onsite or delivered
- Highly convenient for reorganizing your layout
- Uses standard roll up door sizes in over 20 available colors
- Secure and convenient for renters
- Built with special features to reduce moisture
- Easy to add on to accommodate growth
- Units are classified as equipment, which could offer tax incentives
- Adaptable to odd-sized lots or slightly sloped land/driveways
- Standard building permits are not required for portable units
- Economical – increased rental income with a minimal investment
- Retains the look of your existing storage units without the construction costs



*“We have seen three major benefits of utilizing portable storage units. First, there is a tax devaluation because we can classify them as equipment. Second, no building permit is required, and third, their flexibility allows us to place these in areas where permanent buildings are not permitted.”*

—Tim Burnham, Facility Owner

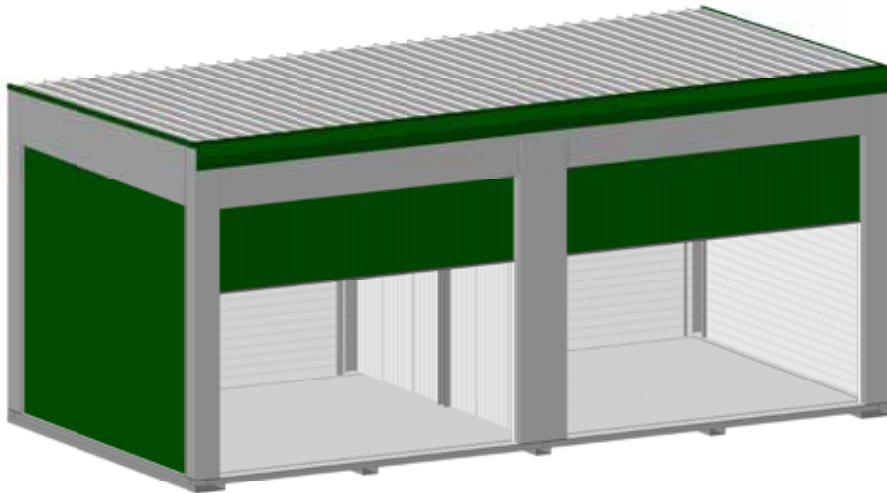

**Features:**

- Configurable mix on a 10'x20' platform
- Sturdy construction
- Can be anchored to asphalt or other ground materials for stability
- Can be wired for electricity
- Uses standard 26 gauge doors in over 20 readily-available colors
- 16 gauge piers and headers built from Janus building components
- 125 psf floor load
- 50 lb. snow load
- Weather resistant
- 20 gauge diamond plate over N-decking
- Special features, including a rain lip and elevated floor, to reduce moisture
- Skid panel outside the doors to offer a non-slip entry into unit
- Units are built close to the ground for easier access
- Utilizes builder grade roofing materials

**Various mix available on 10' x 20' platform**

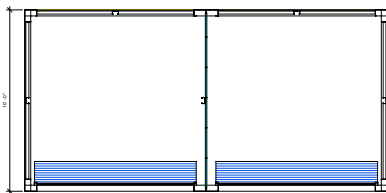

(2) 10 X 10

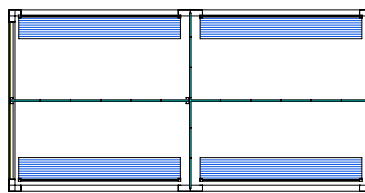

(4) 10 X 5

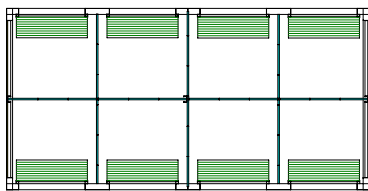

(8) 5 X 5

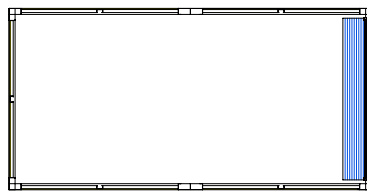

(1) 10 X 20

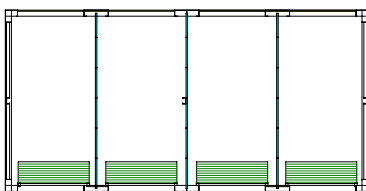

(4) 5 X 10

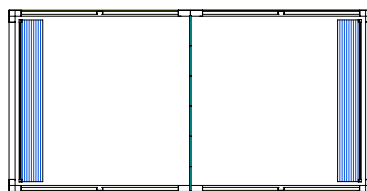

(2) 10 X 10



# Foldable Storage

The Instant Self Storage (ISS™) container was engineered and developed specifically for the self storage industry.

Because it's foldable and movable, it's a cost-effective supplement to traditional self storage facilities that are in need of just a few more units. And because it's a temporary structure classified as equipment, you forgo lengthy and costly building and zoning permits.



## Key Features:

- Foldable, portable and affordable, the ISS™ unit can be assembled and ready to rent in 15 minutes
- Standard size 19'l x 96"h x 93"w (12' and 16' units also available)
- Reconfigurable into single, double, triple or quad units
- Available in 20ga powder coated corrugated or flush panel siding
- Heavy duty metal roof, powder coated for long term durability
- Each door has an interior locking system, handle and interior emergency release
- 3/4" wood floor with top and bottom laminated water-resistant covering
- Forklift sleeves for ease of movement; movable with standard 5,000 lb. forklift
- Structural floor capable of supporting over 10,000 lbs.
- Structural wall frame capable of stacking units 3 high with bottom unit supporting over 25,000 lbs.
- Two runners on bottom of container for protection and durability
- Heavy duty strap and shackle kit for unloading and assembly
- 1 year warranty on material and workmanship

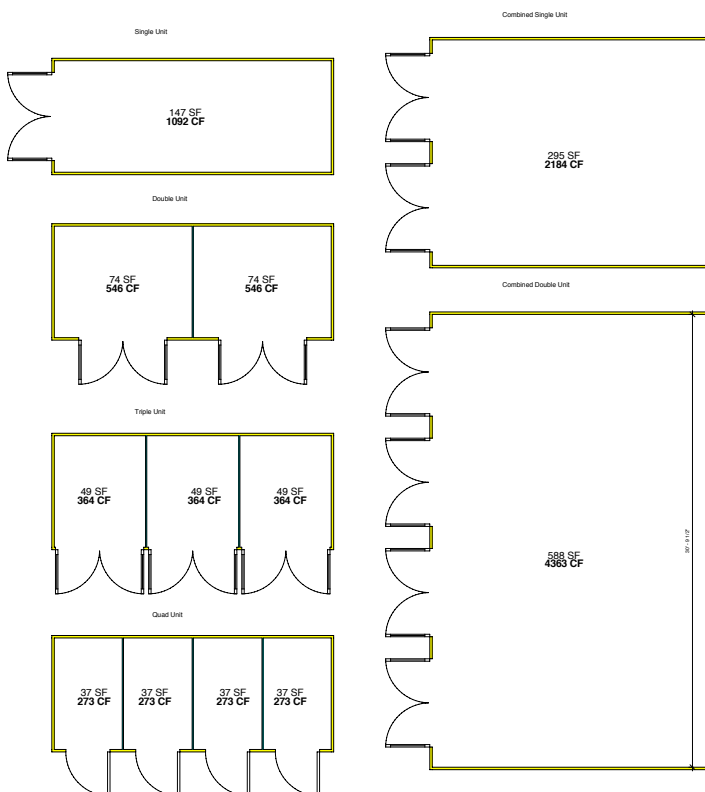

ISS™ units are available in a wide range of configurations.

## Options:

- 8'w x 5'h exterior signage on sides and back for greater facility branding
- 6" castor or roller wheel system for portability
- Welded D-Rings or detachable D-Ring hitch for portable applications
- Interior E-Tracking or tie-down rings for securing goods for portable applications
- Carriage tubes on front and back of base for detachable wheel system
- Multiple units can be joined together to form larger rentable units
- Multiple doors on both ends or other custom configurations available to meet tenant demands
- Optional powder coated colors matching standard pantone color palate
- 10" or 19" rubber wheels detachable from carriage tubes



# Z Box™

## PORTABLE MOVING AND STORAGE

The Z Box™ unit was engineered and developed specifically for the portable moving and storage industry. Because it's foldable and movable, it's a cost-effective supplement to traditional self storage facilities. Available in sizes beginning at 7', the Z Box™ can easily fit into tight spaces or be stored when not in use. And because it's a temporary structure, the Z Box™ is classified as equipment which may offer greater tax benefits.

### Key Features:

- Simple folding design allows unit to be erected or disassembled in less than 15 minutes
- 20 gauge steel with powder coat finish in corrugated or flush panels
- Available in 7', 12', 16' and 19' sizes (custom sizes available with volume orders)
- Secure and weatherproof to protect contents
- The foldable technology allows for significant initial shipping cost savings with 12 to 20 units able to ship in one ocean container
- 3/4" wood floor with top and bottom laminated waterproof covering
- Superior engineering and high grade materials provide less future maintenance costs
- Offers a floorload of 10,000 pounds
- Fully assembled and loaded units can be stacked three high... great for tight spaces or land conservation
- Folded units can be stacked six high for greater warehouse utilization
- Large orders can be customized to meet specific requirements for size, materials, graphics, and interior/ exterior fittings
- Units can be combined to increase size options
- Secure door latch with double lock options
- Forklift sleeves and runners on bottom of base for skid protection
- Heavy duty strap and shackle kit included
- One year warranty on materials and workmanship

### Options:

- Silkscreen signs mounted on long walls
- Single or double swing door options
- 4 Carriage tubes on front and back for detachable wheel system
- 2 carriage tubes center of base for detachable D-Ring bar & pin
- Welded D-rings for portable applications
- Vertical E-Track Strips mounted in the interior
- Tie Down Rings
- 6" castor or roller wheel system for portability
- 10" or 19" rubber wheels detachable from carriage tubes
- Optional powder coated colors matching standard pantone color palate

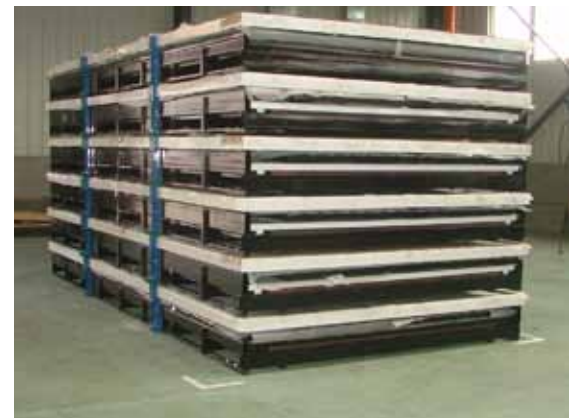

### Quick Assembly

Time is money, and you won't waste a minute on erecting your container. With only two people and minimal tools, you can take the Z Box™ from its compact shipping form to its fully operational size in minutes.



# Stackable Storage

Janus International Stack-n-Store containers offer a vertical storage alternative which provide additional storage while saving valuable land space.

The Stack-n-Store containers are made of CORTEN steel and anti-corrosive paint – the same as a normal ocean container – which is formulated to be weatherproof. These units are easily transported by truck and chassis or a standard forklift, making them a sound investment for temporary, secure storage. Each unit is 20'w x 8'd x 8'6"h and can be partitioned to up to 6 individual units.



## Key Features:



Easy access to upper level



Movable with a 5-ton forklift. 10' unit option



Retrofitted with laminated plywood floors and walls. Floor load 154 psf.



Double side doors option



Three side door option



Four side door option



Five side door option



Six side door option



Option of rear door or doors on both ends

## Warranty Information:

One-year structural warranty and a three-year paint warranty.



# Portable Storage

InstaSpace portable storage units offer a quick solution to temporary space needs for self storage owners.

Easily movable and collapsible, the InstaSpace units allow you to reconfigure your additional storage space in a matter of 20 minutes. These wind- and weather-resistant containers are built to last.

## Option 1

- 8.9' L x 4.6' W x 7.2' H
- side walls and back panel are 0.02" (0.5mm) zinc-plated steel panel laminated with 0.2" (5mm) plywood
- door is 0.02" (0.5mm) zinc-plated steel panel laminated with 0.7" (17mm) thick plywood
- roof is 0.04" (1mm) zinc-plated steel panel insulated with 1.2" (30mm) glass wool
- floor is 0.12" (3mm) checker plate steel panel
- powder coated surface
- gross weight 1,078 lbs. (490kg)
- floor load 154 psf



## Option 2

- 8.9' L x 4.6' W x 7.2' H
- side walls and back panel are 0.16" (4mm) aluminum-plastic composite panel
- door is 0.02" (0.5mm) zinc-plated steel panel laminated with 0.7" (17mm) thick plywood
- roof is 0.04" (1mm) zinc-plated steel panel insulated with 1.2" (30mm) glass wool
- floor is 0.12" (3mm) checker plate steel panel
- gross weight 1,078 lbs. (490kg)
- floor load 154 psf



## Features

- sloped roof to drain water
- louvered panels to maintain air circulation
- self-gauged step board for easy access
- flat-packed or knock-down structure
- easy assembly (takes less than 30 minutes to install)
- 23 standard color choices and shelving
- movable with a forklift when assembled

## Warranty Information:

InstaSpace containers come with a one year structural and three year paint warranty.



**JANUS INTERNATIONAL**

*superior product + recognized value*

**1 866 562 2580**

[www.janusintl.com](http://www.janusintl.com)

*134 janus international blvd.  
temple, georgia 30179*

*13374 west peoria avenue  
surprise, arizona 85379*

*15330 valley view ave, suite 5  
la mirada, california 90638*

*1256 brittmore road  
houston, texas 77043*

*2535 west la palma ave  
anaheim, ca 92801*